

STAGE 1
PLANT THE FOREST

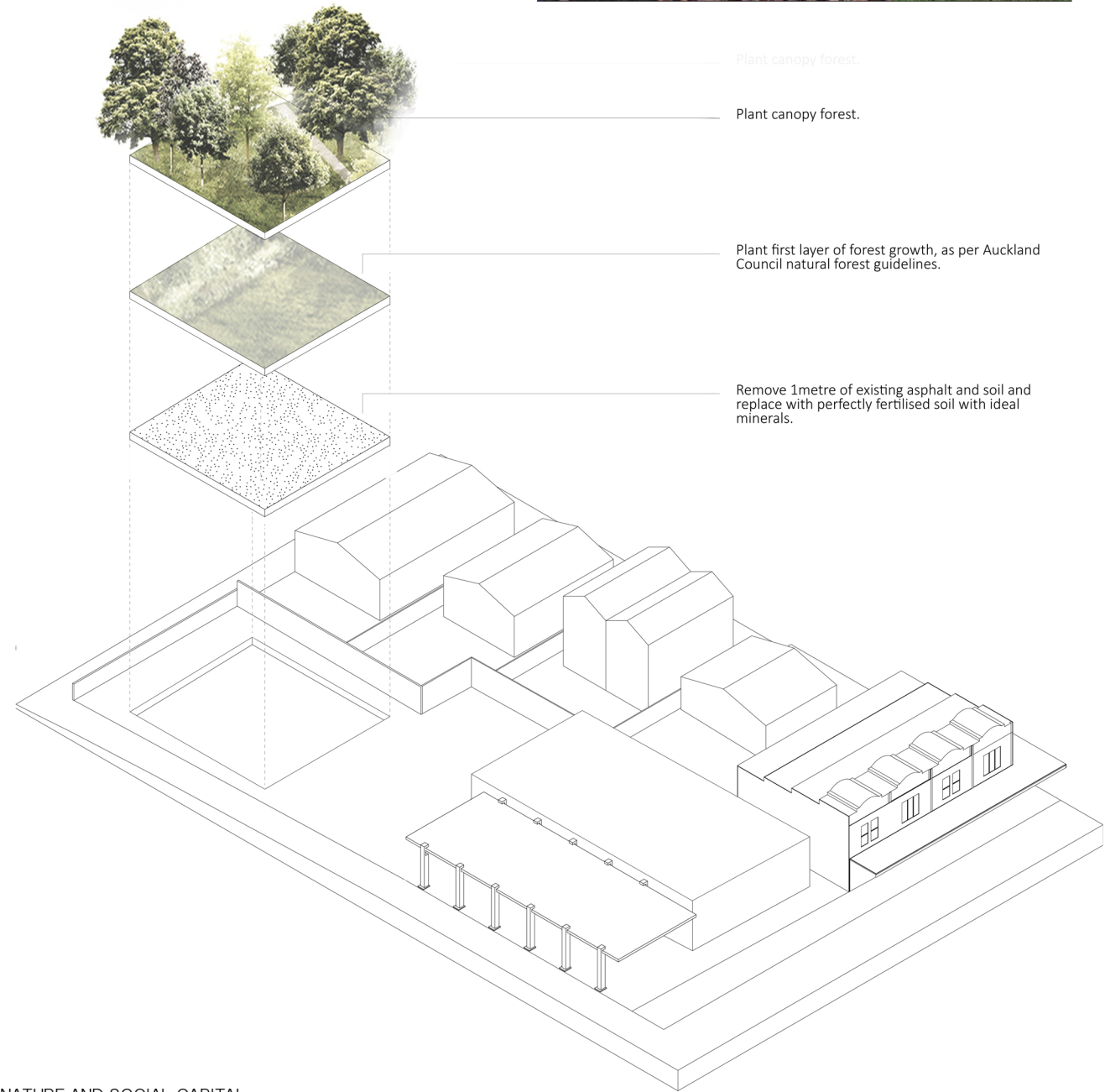

NATURE AND SOCIAL CAPITAL

In May 2016 Shubendu Sharma delivered a TED Talk entitled "How to grow a forest in your backyard." He believes forests should be integrated into urban life because they demonstrate how things can grow faster and stronger if they are grown together. In natural systems, things come together to make a product, and when that product is no longer needed, it decomposes to make its elements available again to make other products. There is no waste. In urban environments we need natural systems to inspire people to start working more effectively together and to make products that can be reused by others rather than just thrown away.

Every element that we need to make a forest is already all around us. We just need to learn from history, from museums, old paintings and poems to find out what grew in this location before. If we bring these elements together in the right proportions, nature will do the rest. In the first stage of the development of Ponsonby Park your community gets together to plant a forest in the park's backyard.

FUNDING: Lump sum funding for generation of forest floor
Crowdfunding for each tree

STAGE 2
UPCYCLING THE CANOPY

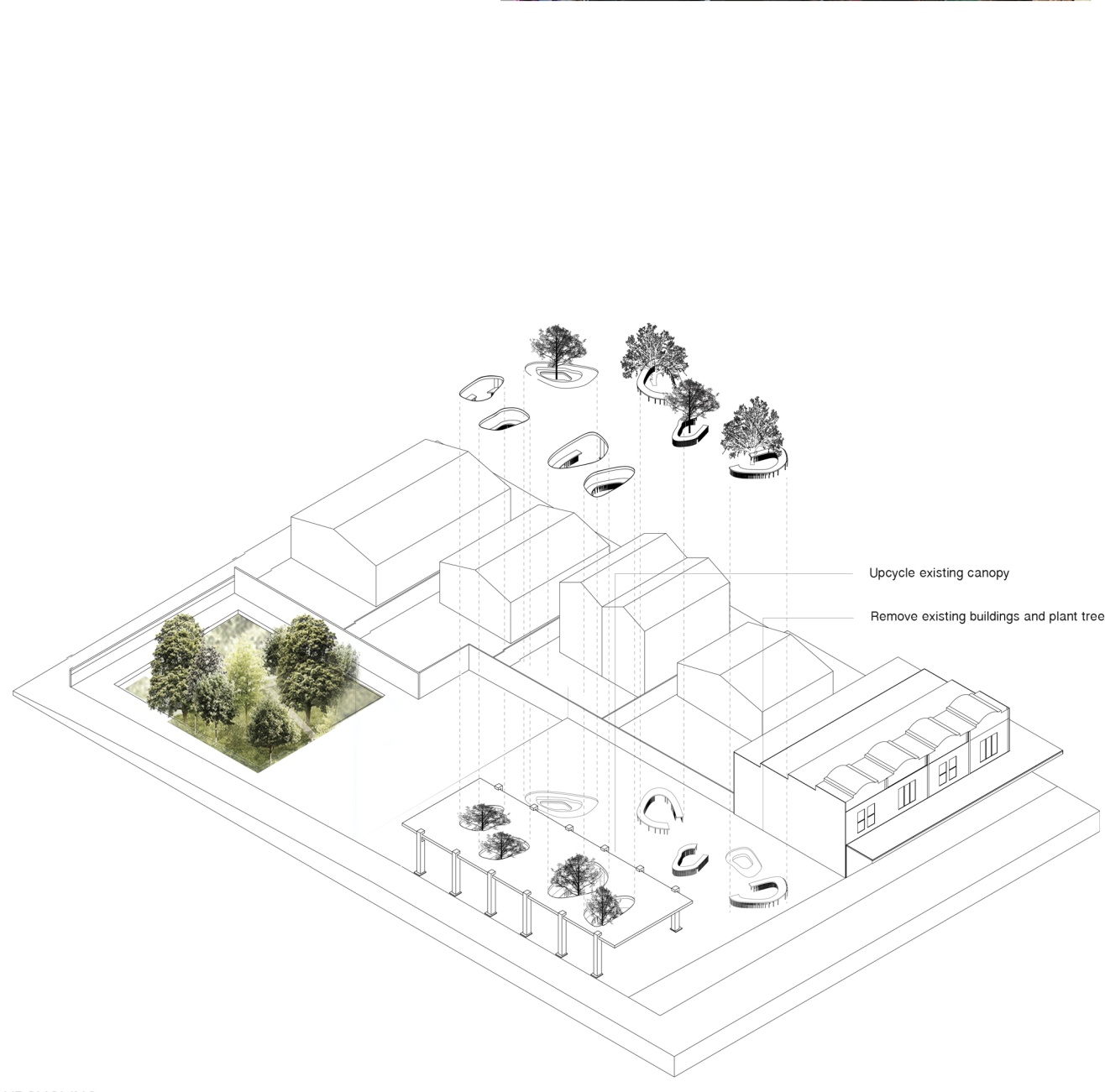

UPCYCLING

The second stage involves a process of upcycling the existing canopy and the removal of the existing buildings in order to provide areas for seating and day/night markets that are protected from the sun and rain.

Sculptural openings will be cut into the canopy creating semi private spaces for people to gather, and events to take place. Timber ribs will be attached to the underside of the canopy creating a surface that reminds us of Ponsonby's rolling topography.

A carefully choreographed set of trees, lighting and seating will be planted across the front half of the park, highlighting the particular characteristics of each tree to generate a nature based day and night sculpture garden for visitors entering off Ponsonby Road.

FUNDING: Lump sum funding for upcycling of canopy
Naming rights sponsorship opportunities for each tree and associated seating

STAGE 3
CONSTRUCTING THE LANTERNS AND BOARDWALK

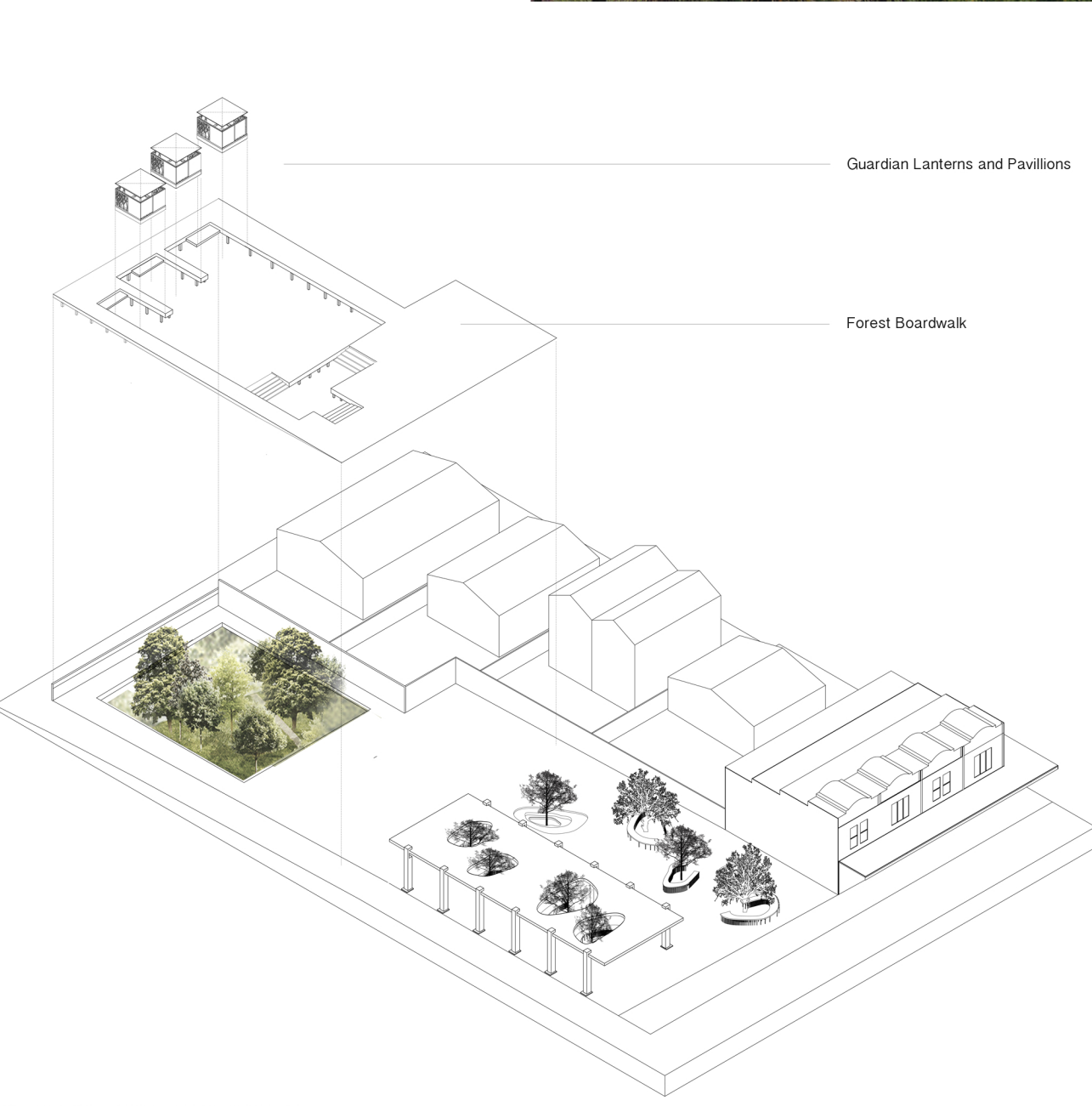

SAFETY, SECURITY AND BELONGING

The third stage involves protecting the forest and ensuring that both the trees and the people using Ponsonby Park are safe and secure. The boardwalk will elevate the people above the forest floor to ensure roots are not damaged and nutrients are contained. The Guardian Lanterns(pavilions) will allow people to see deep into the forest and will ensure that it is well lit at all times. The inverted roof canopies will collect rainwater to ensure all of the trees in the park are adequately hydrated.

The meeting rooms will be able to be booked on a regular basis by groups who are able to take responsibility for the maintenance of the park, They will also be available to locals who wish to celebrate important occasions in the presence of their community

FUNDING: Lump sum funding for boardwalk
3 naming rights sponsorship opportunities for Lantern meeting rooms

STAGE 4
CONSTRUCTING THE PLAYGROUND AND PUBLIC FACILITIES

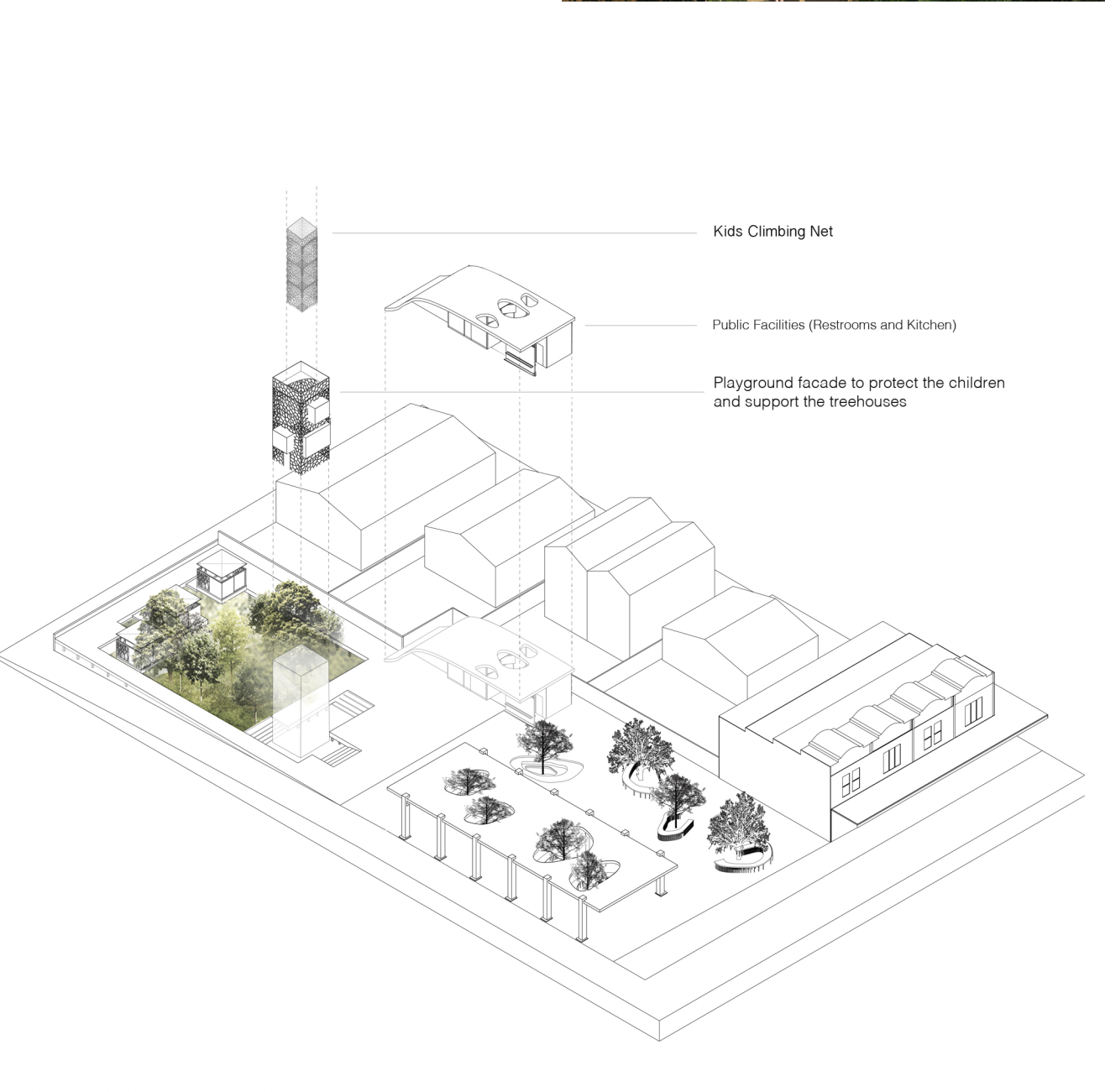

ENTERTAINMENT AND RELAXATION

The fourth stage involves the provision of a place where children, youths, adults and seniors can exist together. A treehouse tower provides a playground and gathering space for children. A net in the centre allows children to climb to individual treehouse rooms held up high by a branch-like frame. From here kids can sit amongst the highest branches of the forest canopy and look out over Ponsonby to understand where they are within the wider world. The same tower holds cinema screens to enable sisters and brothers, parents and grandparents to be entertained while they watch over the children. The tower will remain lit throughout the night

The public facilities building will provide bathrooms and a public kitchen that can be used to support the activities throughout the park

FUNDING: Naming rights sponsorship opportunities for Playground and Public Facilities