

**Ponsonby PARK+**  
**Option 1**  
**27.11.2019**

Option 1

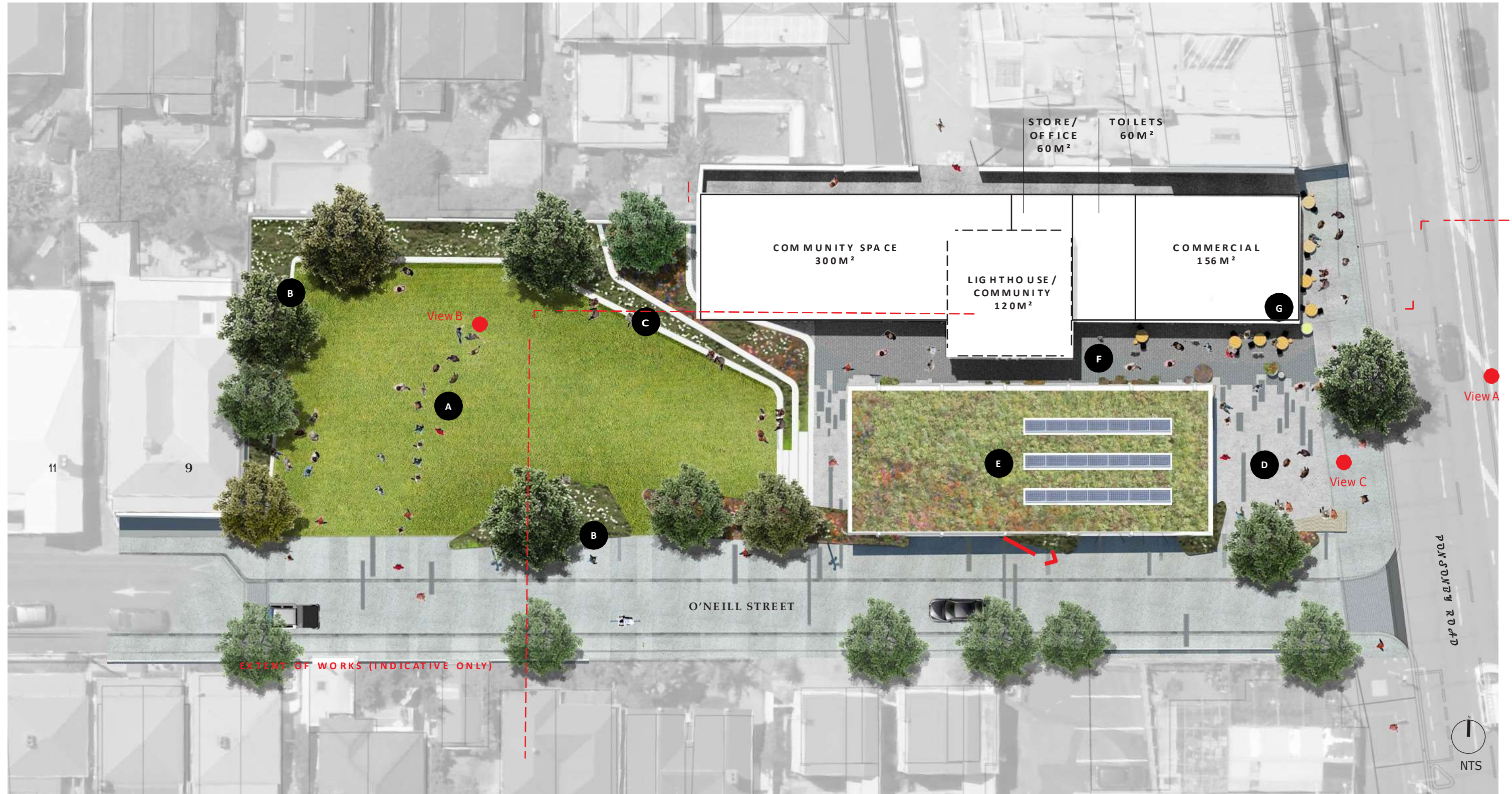





**A THE LAWN** \_ provides a robust and flat lawn (approx 750m<sup>2</sup>) for passive recreation, programmed events and gathering. Located towards the western side of the site and orientated to the afternoon sun. Enclosed by sculptural seating edges providing flexible seating opportunities.

**B PARK GARDENS** \_ a lush, lawn border to the site that provides a filtered edge to adjacent residential activity whilst establishing a new productive ecology for the site.

**C URBAN GARDENS** \_ a themed sequence of garden spaces supporting urban agriculture, indigenous and rare plant species that extends through the Pavilion to meet the street. Provides seasonal displays of colour and texture.

**D THE PLAZA** \_ an intimately scaled, flexible urban space orientated to Ponsonby Road that provides for public occupation of the Ponsonby Road street edge.

**E URBAN CANOPY (RETAINED)** \_ a highly adaptable outdoor room for recreational use with the necessary hard and soft infrastructure to support a community market and range of programmed events. The Pavilion is a gathering space at the heart of Ponsonby for visitors and the local community. This is a new kind of public infrastructural space.

**F THE LANE** \_ a paved urban surface that provides a legible entrance and organising/ connecting space. Supports the proposed retail and community functions on site and connects park and street. Reduced in width from 7.5m to 5m - makes a more intimate lane experience.

**G THE BUILDING** \_ the adaptive re-use of the existing buildings provides for retail/food + beverage and community programs that activate the site.



OPTION 1-VIEW A









OPTION 1- VIEW C

